



Basis of Structural Timber Design  
from Research to Standards

4<sup>th</sup> Workshop

Final Programme

## **Final Programme**

**4<sup>th</sup> Workshop and 4<sup>th</sup> MC Meeting of COST Action FP1402**

**“Analysis and dissemination of the state-of-the-art”**

Université de Mons, Belgium

Monday 26<sup>th</sup> – Tuesday 27<sup>th</sup> September, 2016

### **Local Organizer**

Prof. Thierry Descamps

Université de Mons – Faculté Polytechnique

Department of Structural Mechanics & Civil Engineering

53 Rue du Joncquois, B-7000 Mons

Belgium

Tel.: +32 65 37.45.26

[Thierry.descamps \(at\) umons.ac.be](mailto:Thierry.descamps@umons.ac.be)



## PROGRAMME

### Monday, September 26<sup>th</sup> 2016

- 11:30 - 13:00      Registration – Signing of Attendance list and payment of fee (dinner, EUR45 cash only)  
Main entrance (ground floor – see map)
- 12:00 – 13:00      Lunch at Aud. 5 (ground floor – see map)
- 13:00 – 13:20      Common meeting at Aud. 3 (ground floor – see map)  
Welcome, general information and outline of Workshop
- 13:20 – 14:30      Keynote Lectures:  
dr.ir. A.J.M. Leijten, Eindhoven University of Technology  
Member of the Project Team that drafted Eurocode 5  
*“The development of Eurocode 5”*
- Marjan Popovski, Ph.D., P.Eng., FP Innovations, Canada  
*“The New Canadian Design Provisions for CLT”*
- 14:30 – 14:50      Coffee Break - Aud. 5 (ground floor)
- 14:50 – 16:40      Presentation of results from STSMs - Aud. 3 (ground floor)  
Katrín Kudla (University of Stuttgart)  
*“Notched Connections for TCC Structures as a Part of the Standard”*
- Dr. Wendel Sebastian (University of Bristol)  
*“Simplified Modelling for Multi-Span Continuous Timber Concrete Composite Floors”*
- Elke Mergny (Université Catholique de Louvain)  
*“Properties of Single Fasteners”*
- Michael Schweigler (Vienna University of Technology)  
*“Experimental characterization of the load-to-grain angle depend. embedment behaviour of dowel-type fasteners in LVL”*



Dr. Simone Rossi (University of Trento)

*"Load-Bearing Capacity of Steel-To-Timber Dowelled Joints  
with Multiple Slotted-in-Plates"*

Dr. Robert Jockwer (ETH Zurich)

*"Review of Design Recommendations for Connections  
Loaded Perpendicular to the Grain"*

Andreas Ringhofer (TU Graz)

*"Stiffness Properties of Axially Loaded Self-Tapping Screws"*

16:40 – 17:00 Coffee Break - Aud. 5 (ground floor)

17:00 – 18:00 Management Committee meeting - Aud. 3 (ground floor)

19:30 - 22:30 Dinner at Mons City Hall (reception organized with the kind  
support of the city of Mons).

*Address: Grand Place 22, Mons*

*Coordinates : 50.454804, 3.952304*

*Dress code: Business Casual*



## **Tuesday, September 27<sup>th</sup> 2016**

08:30 – 10:00 WG meetings

WG1: Basis of design – Aud. 23 (2<sup>nd</sup> floor – see map)

WG2: CLT – Aud. 3 (ground floor – see map)

WG3: Connections – Aud. 12 (1<sup>st</sup> floor – see map)

WG4: Hybrid timber structures – Aud. 25 (2<sup>nd</sup> floor)

10:00 – 10:30 Coffee break - Aud. 5 (ground floor)

10:30 – 12:30 WG meetings (continued)

WG1: Basis of design – Aud. 23 (2<sup>nd</sup> floor – see map)

WG2: CLT – Aud. 3 (ground floor – see map)

WG3: Connections – Aud. 12 (1<sup>st</sup> floor – see map)

WG4: Hybrid timber structures – Aud. 25 (2<sup>nd</sup> floor)

12:30 – 13:30 Lunch - Aud. 5 (ground floor)



- |               |  |
|---------------|--|
| 13:30 – 15:30 | WG meetings (continued)  |
| 15:30 – 16:00 | Coffee break - Aud. 5 (ground floor)   |
| 16:00 – 17:00 | Common meeting Aud. 12 (1 <sup>st</sup> floor – see map)<br>Presentation and discussion of results from<br>WG meetings (15 mins each)        |
| 17:00 – 18:30 | Invitation from UMONS - Faculty of engineering, to all<br>participants to a Belgian beers tasting (+ soft drinks) -<br>Aud. 5 (ground floor) |

**For Members who will attend the Meeting of CEN/TC 250/SC 5:**

**Wednesday, September 28<sup>th</sup> 2016**

- |       |   |
|-------|---|
| 07:30 | Meeting at Square Roosevelt (see map) and transfer by<br>private coach to TC250 Meeting venue in Brussels.<br>Brussels airport can be easily reached by subway and train<br>from the "Belgian Institute for Wood Technology" where the<br>CEN meeting takes place |
|-------|---|

Contact Information: Dr. Kurt De Proft ([kurt@wood.be](mailto:kurt@wood.be))



cost  
FP1402

Basis of Structural Timber Design  
from Research to Standards

4<sup>th</sup> Workshop

Final Programme

### Mons, Belgium:



### Workshop venue (see maps in the back for rooms):

Université de Mons – Campus Polytech - Houdain  
rue de Houdain, 9 - 7000 Mons - Belgium.



Coordinates:

50.452213, 3.953138

+50° 27' 7.97", +3° 57' 11.30"



## TRAVEL TO/FROM MONS

To travel to Mons, you can fly to Brussels Airport or Charleroi Airport

### 1. Brussels Airport <http://www.brusselsairport.be/en/>

Brussels airport has good connecting flights to all European airports.

To get to Mons from Brussels Airport, use the train (about 1h15). The airport train station is located below the terminal (basement level -1). According to daytime, up to two trains per hour connect Brussels airport to Mons during weekdays (one direct, one with an easy change at Brussels main station), only one per hour during the weekend. Approximate cost from Brussels to Mons by train: 16 EUR (one-way ticket).



Brussels airport station.

Timetable for trains:

<http://www.belgianrail.be/en/Default.aspx>

Recommendations:

- For the train timetable, see <http://www.belgianrail.be/en/Default.aspx> . For your research, use these names: “Brussels Airport - Zaventem” To/From “Mons [NMBS/SNCB]”. Tickets can be bought online or directly at the station (ticket dispensers or buy your ticket at the ticket counter). If you are unable to buy a ticket ahead of time, get into the train and directly alert the train conductor (to avoid any surcharge). **If you buy your ticket online, you have to print it (electronic tickets on smartphones are not allowed)**. Travelers arriving at, or departing from Brussels airport have to scan their ticket at the gates before entering or leaving the station. So, keep your train ticket with you!
- Belgium has three official languages. Mons is located in the French speaking part of the country. When you get the train at Brussels Airport, remember that the name of “Mons” in Dutch is “Bergen”. Therefore, you might get a train to “Mons” or to “Bergen”, (it is the same!)
- When you are leaving Mons, ask for a train ticket to “Brussels Airport” and not “Brussels”. Fares are different!





- A new train station is under construction in Mons. Please keep in mind that it could take up to 10 Minutes when you are at the temporary train station to get a ticket and go to the platforms.



*Mons station: what it looks like in May 2016 and what it should look like in 20XX*

- Depending to day and time (late arrival for example), it might happen that you do not see any direct train to Mons at the airport. In that case, take any train from the airport to the railway station "Brussels South" ("Bruxelles Midi" in French and "Brussel Zuid" in Dutch). Get off the train in Brussels South station and look for a train to Mons. The last trains to Mons leave Brussels South station around 10:30 PM.

## 2. Brussels South Charleroi Airport <http://www.charleroi-airport.com>

Brussels South Charleroi Airport is located in Gosselies, a part of the city of Charleroi, 45 km from Mons. Many low-cost carriers fly to this airport (Jetairfly, Pegasus Airlines, Ryanair, Wizz Air).

To get to Mons from Charleroi-South airport, first catch a bus (TEC bus) to Charleroi-South railway station. At Charleroi-South station, catch a train to Mons (about 40 Minutes).



*Shuttle buses (TEC) between the airport and Charleroi-South station – bus line A: Single ticket: 5 EUR*

*Timetable: <http://www.charleroi-airport.com/en/acces/train-bus/index.html>*

When you leave Brussels South Charleroi Airport, you can buy a single or return ticket (same day return) to "any Belgian station" from one of the two ticket machines available. This ticket includes the bus journey (from the airport to



Charleroi-South station) and the train journey (from that station to another Belgian station of your choice). Both ticket machines are outside the terminal near Door 2. You can pay using cash or credit/debit card.

For your trip back by train you will arrive at Charleroi-South station, you can just get a direct bus (bus A) and you will be at the airport terminal in 20 minutes. The ticket price includes the train and the bus transfer.

Please also see the recommendations about Mons railway station above.

## TRANSPORTATION IN MONS

*Walking is probably the best way to reach your hotel or University*

Taxis are available at the station. All displacements can be done by feet from the station. It takes about 20' by feet to cross the city.

The Mons line Buses "City'O" and "City'R" operates from 7 am to 6 pm. Both lines deserve the city center. About three or four buses per hour. Price: 2,1 euros. Bus "TEC, 60" Grands Prés" deserve the shopping center and the "Congress" hotel.



*All buses make a stop at the railway station*

*Bus routes:*

[https://www.infotec.be/Portals/0/TEC%20Hainaut/PDF/m onsenbus\\_City\\_O\\_R\\_A4.pdf](https://www.infotec.be/Portals/0/TEC%20Hainaut/PDF/m onsenbus_City_O_R_A4.pdf)

<https://www.infotec.be/Medplacer/Horaires/Ligne/tabid/613/ligne/H1060/titre/60%20Mons%20Grands%20Pr/lan guage/fr-BE/Default.aspx>

## HOTELS IN MONS

We pre-booked rooms in a couple of hotels in Mons at fixed rates. After having received your official e-COST invitation, please kindly proceed your booking as soon as possible!

Locations of the hotels are shown on the map below.

### Hotel Dream

Address	Rue de la grande triperie, 7000 Mons
Website :	<a href="http://www.dream-mons.be/fr/">http://www.dream-mons.be/fr/</a>
Email :	<a href="mailto:info@dream-mons.be">info@dream-mons.be</a>





Information : Single or double room: 83€ per night + breakfast 12,5€  
Rooms will be kept until 29/07/16. Beyond this date, the availability and price are no longer guaranteed.

Walking distance: 1 min

Booking code : Workshop bois UMONS COSTFP1402

#### Hotel Lido

Address Rue des Arbalestiers, 112 - 7000 Mons

Website : <http://www.lido.be/>

Email : [info@lido.be](mailto:info@lido.be)

Information : Single room: 92€ per night (breakfast included)  
Double room: 105€ per night (breakfast included)  
Rooms will be kept until 29/08/16 (at this rate).

Walking distance: 12 min

Booking code : GS 4764 « Workshop bois UMONS COSTFP1402 »

#### Hotel Infotel

Address Rue d'Havr , 32 - 7000 Mons

Website : <http://www.hotelinfotel.be>

Email : [info@hotelinfotel.be](mailto:info@hotelinfotel.be)

Information : Standard room, single: 91,5€ per night (breakfast included)  
Standard room, double room: 103,5€ per night (breakfast included)  
Rooms will be kept until 25/08/16 (at this rate).

Walking distance: 4 min

Booking code : Book your room by email ([info@hotelinfotel.be](mailto:info@hotelinfotel.be)) with the following booking code: G36026 « Workshop bois UMONS COSTFP1402 »

#### Hotel Congres Van Der Valk

Address Avenue Melina Mercouri, 7 - 7000 Mons

Website : <https://www.hotelmons.eu>

Email : [info@hotelmons.eu](mailto:info@hotelmons.eu)

Information : Single room: 91€ per night + breakfast 15€  
Double room: 91€ per night + breakfast 15€  
Rooms will be kept until 25/07/16. Beyond this date, the availability and price are no longer guaranteed.

Walking distance: 16 min (at the station, use the pedestrian bridge that goes over the tracks)

Booking code : Workshop bois UMONS COSTFP1402. Use for your booking the form given in the annex.



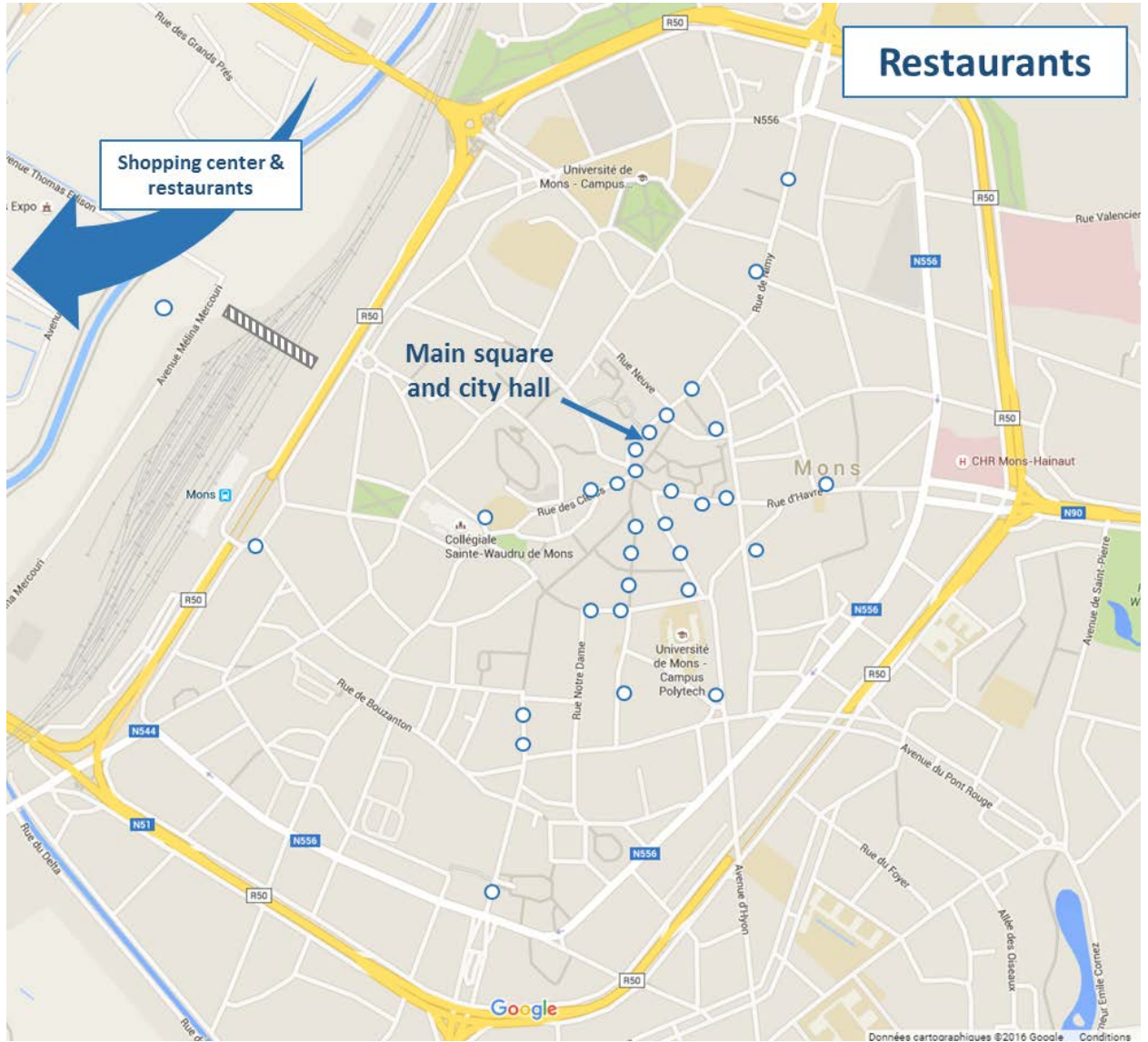



### Maps of the meeting venue – Université de Mons – Campus Polytech

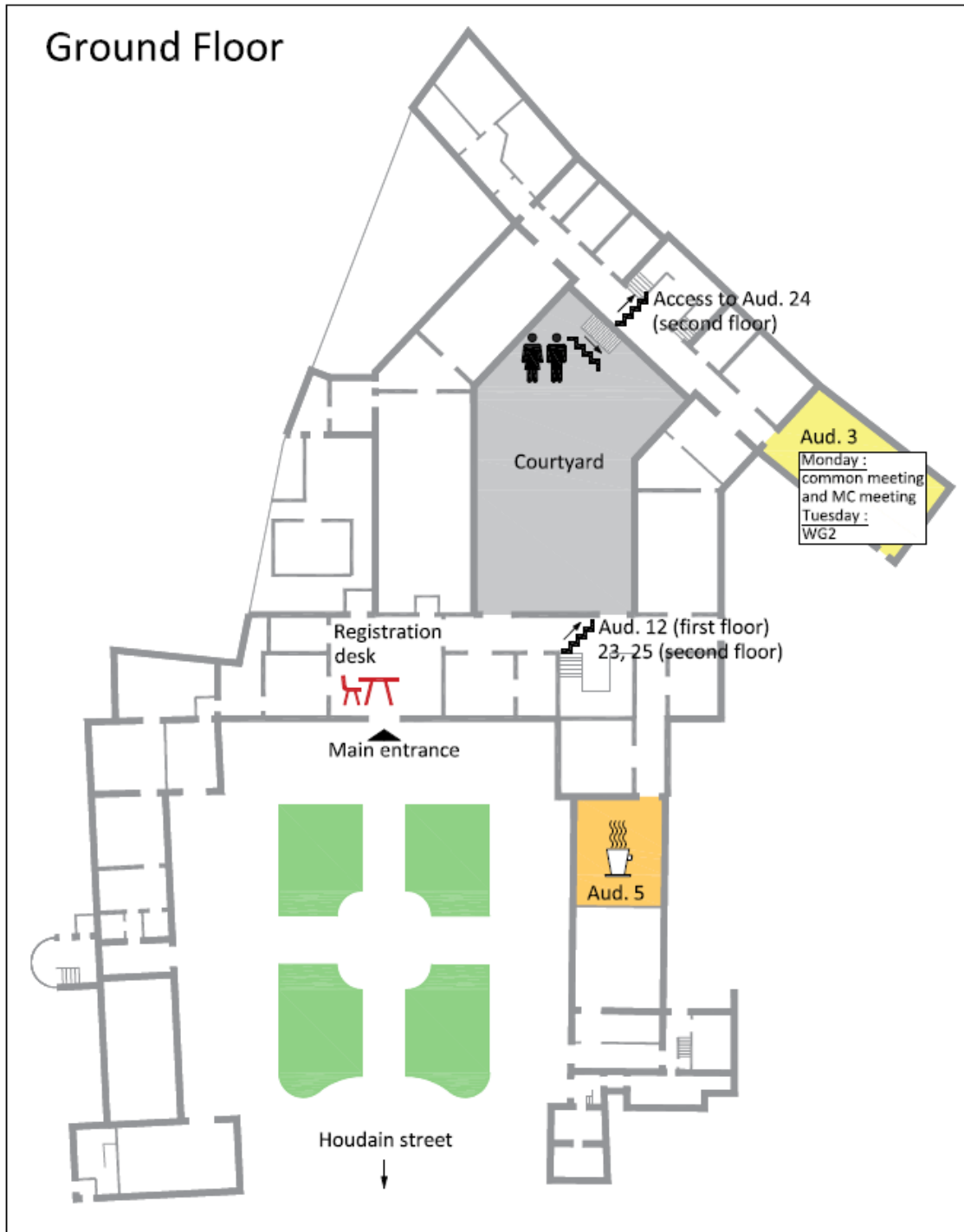

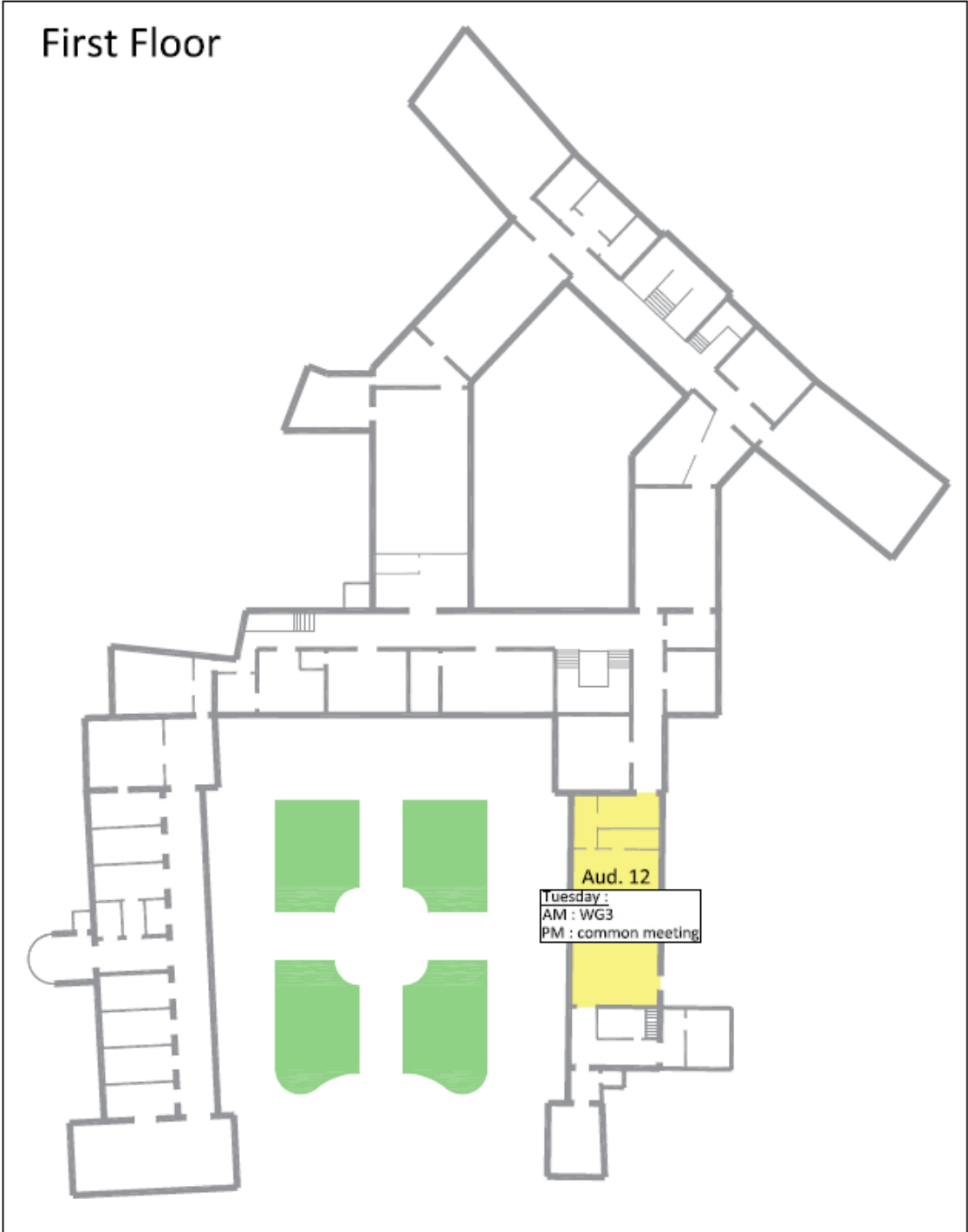



4<sup>th</sup> Workshop

Final Programme

